

P1 (B1) 14x50 N máx = 160 1ø25  
 P2 (B2) 14x50 N máx = 308 2ø25  
 P3 (B3) 14x50 N máx = 250 2ø25  
 P4 (B4) 14x50 N máx = 334 2ø25  
 P5 (B5) 14x50 N máx = 272 2ø25  
 P6 (B6) 16x50 N máx = 364 2ø25  
 P7 (B7) 16x50 N máx = 250 2ø25

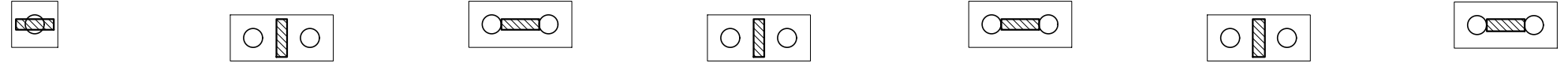

P8 (B8) 14x50 N máx = 352 2ø25  
 P9 (B9) 16x50 N máx = 315 2ø25  
 P10 (B10) 16x50 N máx = 449 3ø25  
 P11 (B11) 16x40 N máx = 414 3ø25  
 P12 (B12) 16x50 N máx = 454 3ø25  
 P13 (B13) 16x50 N máx = 396 3ø25  
 P14 (B14) 16x50 N máx = 410 3ø25

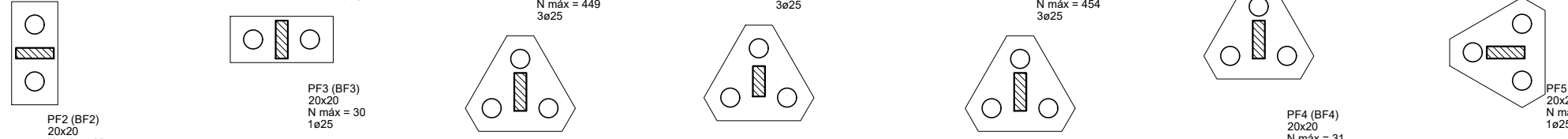

PF2 (BF2) 20x20 N máx = 32 1ø25  
 PF3 (BF3) 20x20 N máx = 30 1ø25  
 PF4 (BF4) 20x20 N máx = 31 1ø25  
 PF5 (BF5) 20x20 N máx = 33 1ø25



P15 (B15) 14x50 N máx = 215 2ø25  
 P16 (B16) 14x50 N máx = 323 2ø25  
 P17 (B17) 14x40 N máx = 247 2ø25  
 P18 (B18) 14x50 N máx = 264 2ø25  
 P19 (B19) 14x40 N máx = 248 2ø25  
 P20 (B20) 14x50 N máx = 325 2ø25  
 P21 (B21) 14x50 N máx = 215 2ø25

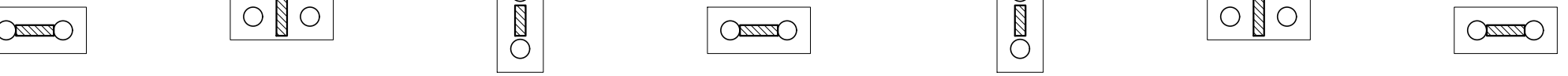

OBS.: TODAS AS CARGAS ESTÃO EM KN.

Planta de locação escala indefinida

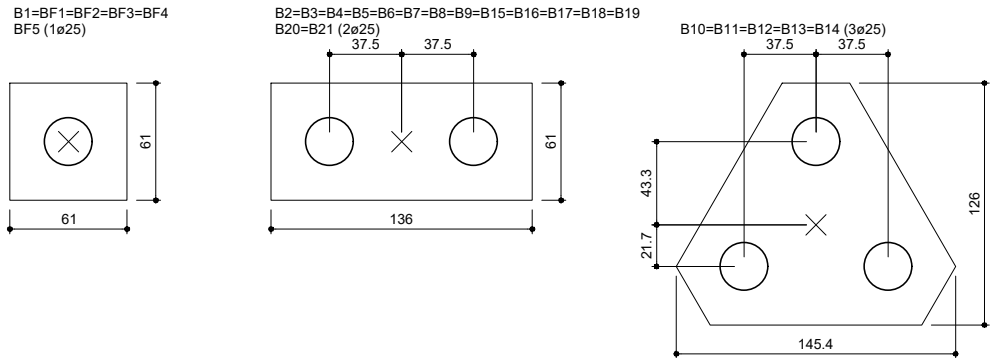

Legenda dos blocos escala indefinida